

Soakaway Kit



SOAK 1



Install +

Soakaway
Kit for
Condensing
Boilers

‘Soak Up’ Boiler condensate with our soakaway!

Where a suitable gravity drain is not available the soakaway can be used in conjunction with 10mm lime chippings. Compatible with the following pipe sizes: 22mm (3/4") overflow, 32mm (1-1/4") and 40mm (1-1/2").

Related Products

ASHP Soakaway
PVC Coated Insulation

The Package

- Soakaway
- Inlet - 22mm / 32mm / 40mm
- Side or Top Inlet

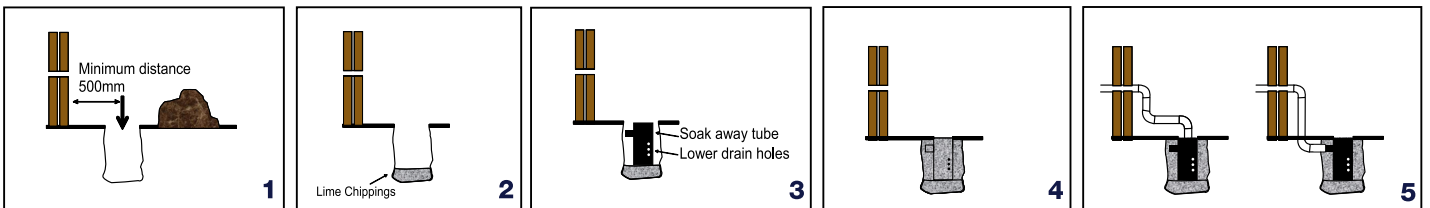

1. Dig hole (min depth) 400mm x 300mm in diameter, at least 500mm from the wall

2. Fill the bottom of the hole with 100mm depth of lime chippings.

3. Insert the soakaway tube with the lower drain holes facing away from the property.

4. Fill the remaining part of the hole and tube with lime chippings

5. Feed the pipework either into the top or through the side of the soakaway.

Part Code	Description	Height	Diameter	Inlet
SOAK1	Soakaway Kit for Condensing Boilers	300mm	110mm	22mm / 32mm / 40mm

The Pump House sales team are available to answer your questions or queries on this product. Our experts are waiting for your call **+44 (0)115 900 5858** or if you prefer send an email to **sales@pumph.co.uk** or visit **www.pumph.co.uk**

